

1968-1972 CHEVELLE CENTER CONSOLE CUPHOLDER KIT INSTRUCTIONS

TOOLS REQUIRED:

Phillips screwdriver
Side-cutter pliers or dremel
Wire crimpers or pliers

PARTS INCLUDED:

- Center Console Plate
- LED Cupholders (X2)
- Cupholder insert
- LED Shift Indicator Bulb
- Voltage Regulator
- Voltage Regulator Mount
- Butt Splices (X2)
- Heat Shrink Sleeves (X2)

PACKAGED BY: _____

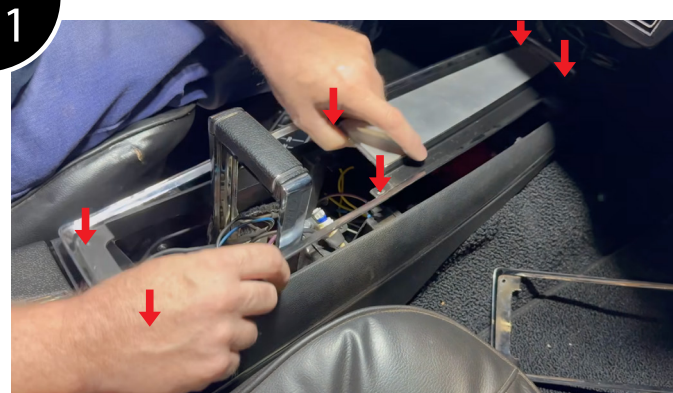

1 Remove the six screws from the center console plate and remove the plate from the center console.

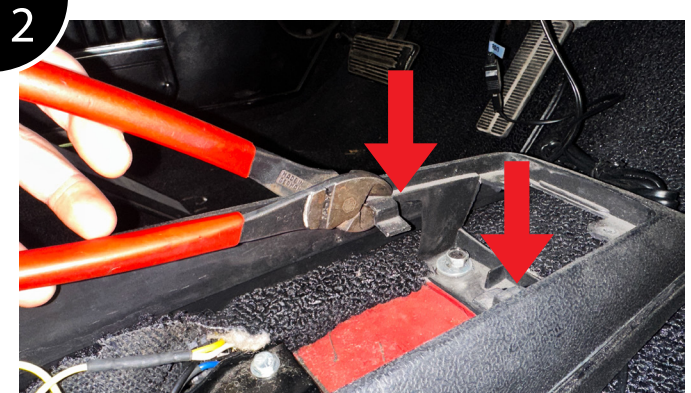

2 Cut away the two tabs in the center console that interfere with the cupholder kit using side-cutter pliers or a dremel.



3 Remove both bulbs from the shift indicator plate. Replace one of the bulbs with the supplied LED bulb. Only one bulb is needed, as the LED bulb is significantly brighter than original.

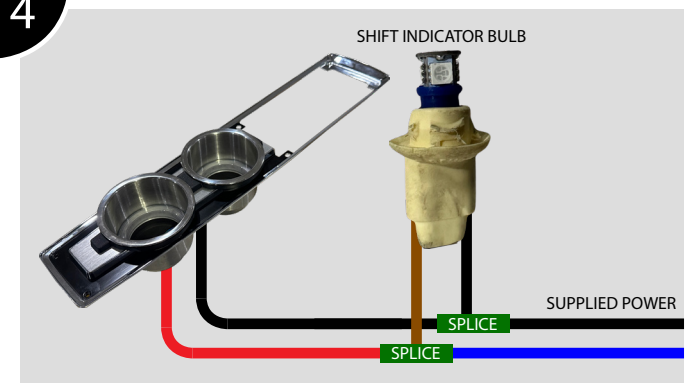

4 Splice the cupholder wires in with the shift indicator bulb and the wires powering the bulb according to the diagram.

11



Reassemble the center console with the new assembly. If fitment is too tight, some modification for perfect fitment with OEM center consoles may be needed.

6



Enjoy your new LED cupholder center console!

Feel free to call us at 262-HOTRODS, or email us at info@studiohotrods.com if you have any questions about your install. Thank you for your order!